

---

## MECHANICAL REINFORCING BAR SPLICING SYSTEM

---

# doubleCOUP Coupler

### PROPERTIES

---

- Meets or exceeds the requirements of major international building codes
- A wide range of international rebar grades and deformation patterns can be used
- Upset heads can be field or shop fabricated
- Installs easily and fast
- Available in sizes 12 mm - 36 mm
- Allows simple visual inspection



Doublecoup Couplers are designed to splice the same diameter bars where none of the bars can be rotated and moved freely in its axial direction. Two parts of the coupler are machined to get parallel threads inside which create a mechanical sleeve between corresponding reinforcing steels. Upsetting of rebar ends can be fabricated in field or shop.

Typical applications include splicing of the column bars (or shearwalls), bent bars, pre-tied cages, splicing of the beam bars, future extensions.

Barcoup couplers are designed to meet or exceed major international building including:

AASHTO	ACI 349	IBC Type 1 (125% Specified Yield)	NF A 35-020-1
ABNT NBR 8548:1984	ACI 359	IBC Type 2 (Specified Ultimate)	NF EN 1992-1-1
ACI 318 Type 1 (125% Specified Yield)	AS3600	ISO 15835	Turkish Seismic Code 2018
ACI 318 Type 2 (Specified Ultimate)	Eurocode 2	GOST 34278	US Army Corps of Engineers

### SIMPLE INSTALLATION

---

#### HEADQUARTERS

Caferağa Mah. Albay Faik Sözdener Cad.  
No:7/23 Kadıköy- İstanbul / TURKEY  
Phone : +90 216 405 21 55 / PBX  
info@regbar.com

#### PLANT

Sanayi Mah. İzmit Sanayi Sitesi  
13. Cadde 318 Blok Apt. No:318/132  
No:9 İzmit-Kocaeli / TURKEY  
Mobile: +90 541 932 3751

#### RUSSIA BRANCH:

Lesnaya Plaza 4, 4th, Lesnoy Pereulok  
No:24/8125047 Moscow / RUSSIA  
W: +7 (495) 641 37 64

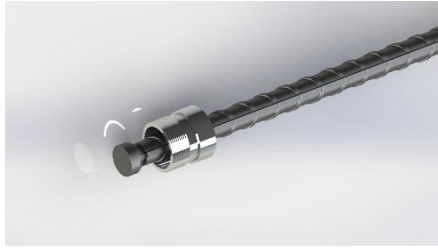

1. Assemble the first part of the coupler to the reinforcing bar.

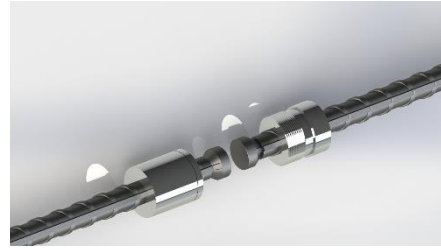

2. Align the corresponding rebar. Rotate the other part of coupler to create a mechanical connection.

Product Code	Bar Sizes			Outside Diameter (*)		Total Length		Unit Weight (*)	
	Metric [mm]	US	Canada	[mm]	["]	[mm]	["]	[kg]	[lb]
DBCP12	12	#4	10M	35	1-3/8	51	2	0.07	0.16
DBCP16	16	#5	15M	38	1-1/2	54	2-1/8	0.16	0.36
DBCP20	20	#6	20M	41	1-5/8	60	2-3/8	0.24	0.53
DBCP22	22	#7	-	48	1-7/8	73	2-7/8	0.31	0.69
DBCP26	26	#8	25M	54	2-1/8	79	3-1/8	0.34	0.75
DBCP28	28	#9	30M	60	2-3/8	89	3-1/2	0.49	1.09
DBCP32	32	#10	-	67	2-5/8	95	3-3/4	0.68	1.5
DBCP36	36	#11	35M	73	2-7/8	108	4-1/4	0.91	2.01

(\*) Bar diameters and weights may vary by country.

#### NOTES

- Dimensions shown in chart are typical.
- Refer to the complete product installation instructions before starting the installation.

Regbar Construction  
Reinforcing Bar  
Splicing System  
<http://tiny.cc/regbar>



#### HEADQUARTERS

Caferağa Mah. Albay Faik Sözdener Cad.  
No:7/23 Kadıköy- İstanbul / TURKEY  
Phone : +90 216 405 21 55 / PBX  
info@regbar.com

#### PLANT

Sanayi Mah. İzmit Sanayi Sitesi  
13. Cadde 318 Blok Apt. No:318/132  
No:9 İzmit-Kocaeli / TURKEY  
Mobile: +90 541 932 3751

#### RUSSIA BRANCH:

Lesnaya Plaza 4, 4th, Lesnoy Pereulok  
No:24/8125047 Moscow / RUSSIA  
W: +7 (495) 641 37 64